

ORDINANCE NO. 6780

AN ORDINANCE authorizing the transfer of a sewer system from Sewerage and Drainage District No. 4 to King County.

PREAMBLE:

The Council of King County finds that the transfer of the sanitary sewer system operated by King County Sewerage and Drainage District No. 4 to King County pursuant to the attached agreement is in the public interest and is conducive to the public health, safety, welfare, and convenience.

BE IT ORDAINED BY THE COUNCIL OF KING COUNTY:

SECTION 1. The County Executive is hereby authorized to execute the attached agreement transferring the sanitary sewer system operated by King County Sewerage and Drainage District No. 4 to King County.

SECTION 2. The County Executive is also hereby authorized to petition the Superior Court for a decree approving and directing that said sanitary sewer system be transferred according to the terms and conditions of the attached agreement.

INTRODUCED AND READ for the first time this 30th day of April, 19 84.

PASSED this 14th day of May, 19 84.

KING COUNTY COUNCIL
KING COUNTY, WASHINGTON

Gary Grant
Chairman

ATTEST:

Dorothy M. Owens
Clerk of the Council

APPROVED this 22nd day of May, 19 84.

Randy R. Wells
King County Executive

6780

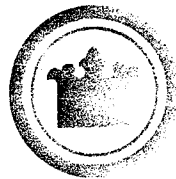

King County Executive
Randy Revelle
Department of Public Works
Donald J. LaBelle, *Director*

TO WHOM IT MAY CONCERN:

By Resolution No. 9668, dated June, 1945, the King County Commissioners appointed the County Road Engineer as Supervisor of King County Sewerage and Drainage District No. 4 and delegated to him the governing authority for the District, as provided in RCW 85.08.300. Since the time of that appointment and delegation, the general duties of the King County Road Engineer have been assigned, in part, to the Director of the King County Department of Public Works. These positions share the function of governing the District.

In our capacity as governing authority for the District, we have reviewed the proposed transfer and the terms and conditions of the transfer agreement which is attached. We find that this transfer and agreement are in the public interest and conducive to the public health, safety, welfare and convenience and hereby approve of its execution.

Dated this 12th day of April, 1984.



DONALD J. LABELLE
Director of Public Works



PAUL C. HOOPER, P.E.
County Road Engineer

AGREEMENT TRANSFERRING

SANITARY SEWER SYSTEM

THIS AGREEMENT is made and entered into by and between King County, hereinafter called the "County", and King County Sewerage and Drainage District No. 4, hereinafter called the "District." The purpose of the agreement is to transfer the sanitary sewer system operated by the District under RCW 85.08 to County operation under RCW 36.94. The agreement is based upon the following facts:

1. The County is a home-rule charter county under the laws of Washington. It is empowered to operate and accept transfer of sanitary sewer systems pursuant to RCW 36.94.

2. Supervision and management of the District was delegated to the county engineer by King County Resolution No. 9668, pursuant to RCW 85.08.300, which powers have devolved upon the Director of the County Department of Public Works and the County Road Engineer. This agreement is therefore executed on behalf of the District by both said Director of the County Department of Public Works and by said County Road Engineer.

3. The District is the owner of a certain sanitary sewer system located within King County. The location, size and other features of the system are specifically described in the February, 1984 Skyway Comprehensive Plan; a copy of which is attached hereto as Addendum A and incorporated herein by this reference. The

physical components of the system include sanitary sewer lines, manholes, side sewers, lift stations and necessary appurtenances.

4. In addition to the physical components of the sanitary sewer system itself, the District owns certain maintenance and office equipment and supplies, described in Addendum B, which is attached hereto and incorporated herein by this reference.

5. The District owns certain easements of record which permit it to construct and maintain its facilities on private property.

6. The District owns an interest in certain real property, described more fully in Addendum C, a copy of which is attached hereto and incorporated by this reference.

7. The King County Council, in its Ordinance No. _____, has found that transfer to the County of the sewer facilities and other assets as well as the indebtedness of the District would be in the public interest and conducive to the public health, safety, welfare and convenience.

8. The District, by and through the Director of the County Department of Public Works and County Road Engineer, has also found, by letter dated _____, that such a transfer would be in the public interest and conducive to the public health, safety, welfare and convenience.

NOW THEREFORE, the parties hereto agree as follows:

A. All sanitary sewer lines, manholes, side sewers, lift stations, and necessary appurtenances owned by the District shall hereby be transferred to and become the property of the County.

B. All maintenance and office equipment and supplies described above shall hereby be transferred to and become the property of the County.

C. All rights to easements owned by the District shall hereby be assigned and transferred to the County.

D. All interests in real property owned by the District shall hereby be assigned and conveyed to the County.

E. The County shall, upon such transfers, assume responsibility for providing the services, maintenance and operation and all other administrative and financial duties of the District.

F. The effective date of the above-described transfers shall be _____, 1984.

G. The District may be dissolved by decree of the Superior Court effective as of the date of the above-described transfers.

KING COUNTY

KING COUNTY SEWERAGE AND
DRAINAGE DISTRICT NO. 4

By _____

By _____

Title _____

Director
Department of Public Works

Approved as to form:

By _____

Deputy Prosecuting Attorney

King County Road Engineer

SEWERAGE GENERAL PLAN
FOR
S K Y W A Y
KING COUNTY SEWER UTILITY
DEPARTMENT OF PUBLIC WORKS

February, 1984

ADDENDUM A

This general plan has been prepared to satisfy the requirements of K.C.C. 13.24 and RCW 36.94, prior to changing the operating authority of the district from the Diking and Drainage Act, RCW Title 85, to the County Services Act, RCW 36.94.

An environmental checklist has been circulated and a Declaration of Non-Significance prepared.

TABLE OF CONTENTS

Skyway Sewerage and Drainage District No. 4

Sewerage General Plan

	Page
Background	1
Sub-Basin Identification	2
Topography and Soil Description	2
Intergovernmental Agreements	2
Existing Collection System	3
Future Additions	4
Land Use	4
Population	6
Design Standards	6
Finances	9

BACKGROUND

The Skyway sewer system currently serves approximately 270 acres, located within unincorporated King County along the southern edge of the City of Seattle (See Figure 1). The system is north of the cities of Renton and Tukwila.

Sewer service to the areas adjacent to the service area is provided by the City of Seattle to the north, the Bryn Mawr Sewer District and the City of Renton to the east, the Cities of Renton and Tukwila to the south and the proposed Langston Sewer ULID to the west.

The original Skyway system was built in 1942 and 1943 by private developers. The system included treatment facilities and was designed to serve the housing projects constructed by the developers. When the housing projects were nearing completion, the developers successfully petitioned the County to organize a sewerage and drainage district under the provisions of RCW 85.08 for the area of the development and deeded over the sewer facilities to the newly formed district. The resolution creating the district was passed by the County Commission on October 25, 1943. The County assumed responsibility for operating and maintaining the district. With the exception of a subdistrict added in 1966, the majority of the present system is the result of developer extensions and individual connections.

The treatment facilities of the original system were turned over to Metro in 1962 pursuant to the agreement between Metro and Sewerage and Drainage District No. 4 that provided for Metro treatment of sewage collected by that District. Metro subsequently removed the treatment plant and routed the effluent to the West Point Metro plant for treatment.

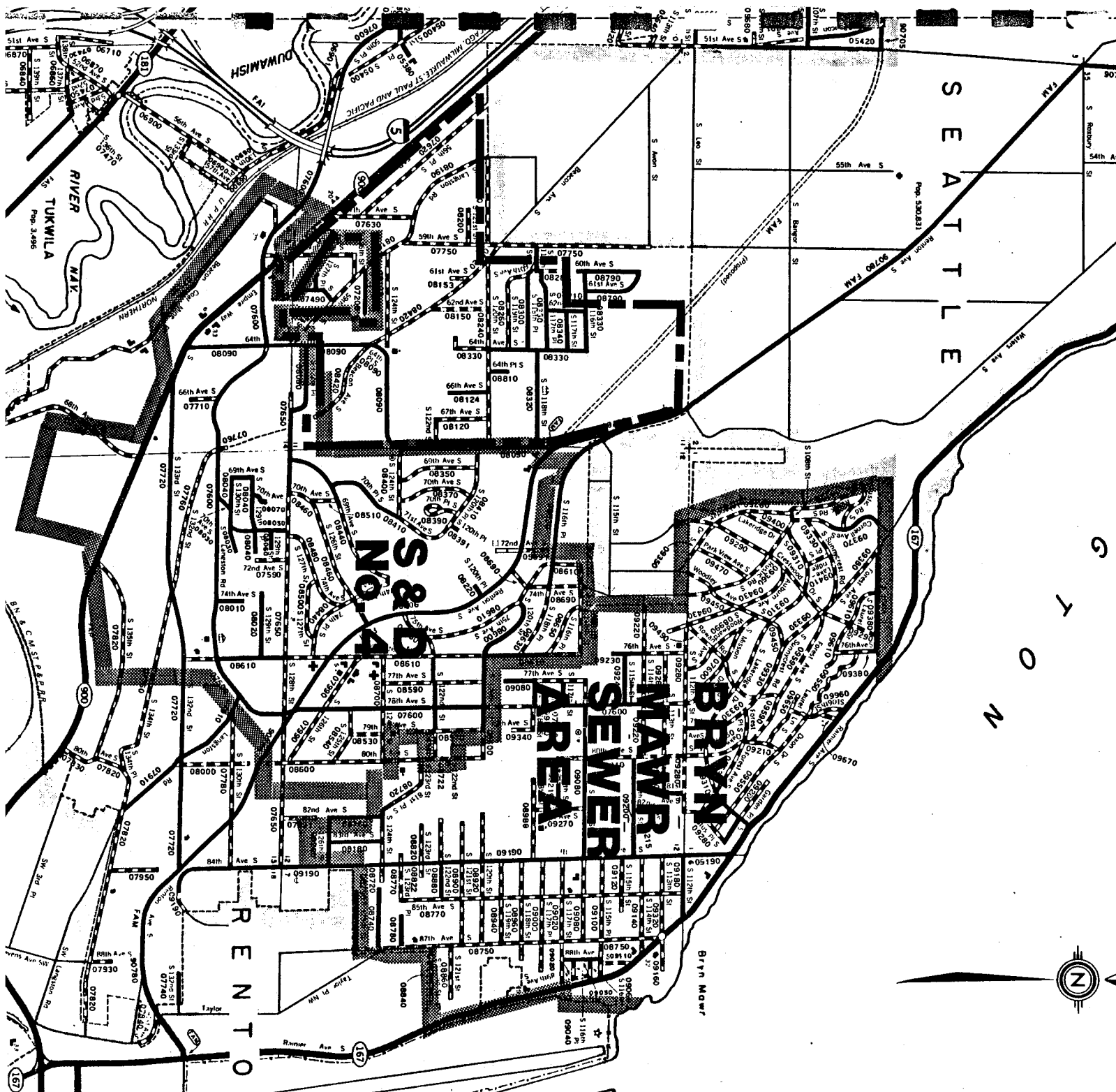

SEATTLE

TOWN



SUB-BASIN IDENTIFICATION

The following sewer general plan is a portion of four separate sub-basins designated as SLW-31, SWW-1, SWW-2, and EB-1 in the approved comprehensive sewer plan entitled "Metropolitan Seattle Sewerage and Drainage Survey," dated May 19, 1958. SWW indicates drainage into the Southwest Lake Washington basin, EB indicates drainage into the Elliott Bay basin, and SLW indicates drainage into the South Lake Washington basin.

The study and report were prepared by the firm of Brown and Caldwell and subsequently adopted by resolution by the Municipality of Metropolitan Seattle. Figure 2 indicates the drainage basins in the Skyway vicinity.

TOPOGRAPHY AND SOIL DESCRIPTION

The topography in the vicinity of the district consists of gently rolling terrain with drainage generally flowing to the southwest. Figure 2 indicates the topographic characteristics of the area.

A high percentage of the soils in the area are classified as Alderwood with some small areas of glacial till and others of Woodinville-Oridia classification. A small portion of the area is underlaid with sub-eocene basalt.

INTERGOVERNMENTAL AGREEMENTS

A County-wide sewer agreement has been negotiated between King County and Metro. The County-Metro agreement, which provides for Metro treatment of sanitary sewage collected by the County has been executed and is in force. An environmental assessment was prepared and circulated.

WASHINGTON

SEATTLE

Bryn Mawr

RENTON

SEATTLE

Bryn Mawr

Black River

14 RIVER

13

Black River

Fukwila

23

23

24

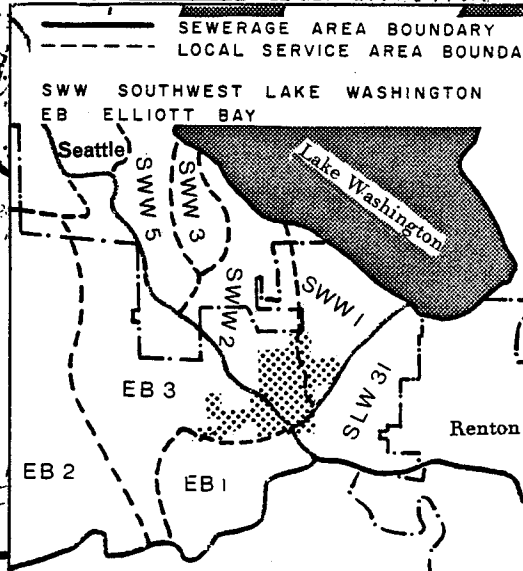

Figure

In 1975, the County entered into an agreement with the City of Seattle to provide a portion of the matching funds required for construction of the Empire Way S. sewer interceptor. The County share is proportionate to the area served by the interceptor in unincorporated King County.

A 1979 agreement between the County and Water District 125 transferred a small sewer system of 52 connections in the Skyway area from the water district to the County, effective January 1, 1980. A 1979 agreement between Metro and King County transferred responsibility for the portion of the system which transported effluent from Empire Way to the Metro force main in Beacon Coal Mine Road. This connection has since been abandoned and the effluent is pumped to the Empire Way S. Interceptor.

The City of Seattle recently completed construction of a sewer ULID No. 6700 which will provide sewer service to some homes located within King County bordering on the proposed Langston ULID.

EXISTING COLLECTION SYSTEM

Figure 3 indicates the existing collection system. The system serves 763 residential and 58 commercial connections. Ten of the commercial connections provide service to a total of 550 apartment, condominium and mobile home units. The system consists of approximately 61,000 feet of sanitary sewer line and four lift stations. The lift station located at 11909 Renton Avenue South also has office and shop facilities for the two County Operations employees normally assigned to operating and maintaining the County-operated sewer systems.

Most of the effluent from the system is transported to Metro via an interceptor jointly financed and operated by the City of Seattle and King County.

SEATTLE

SEATTLE

SEATTLE

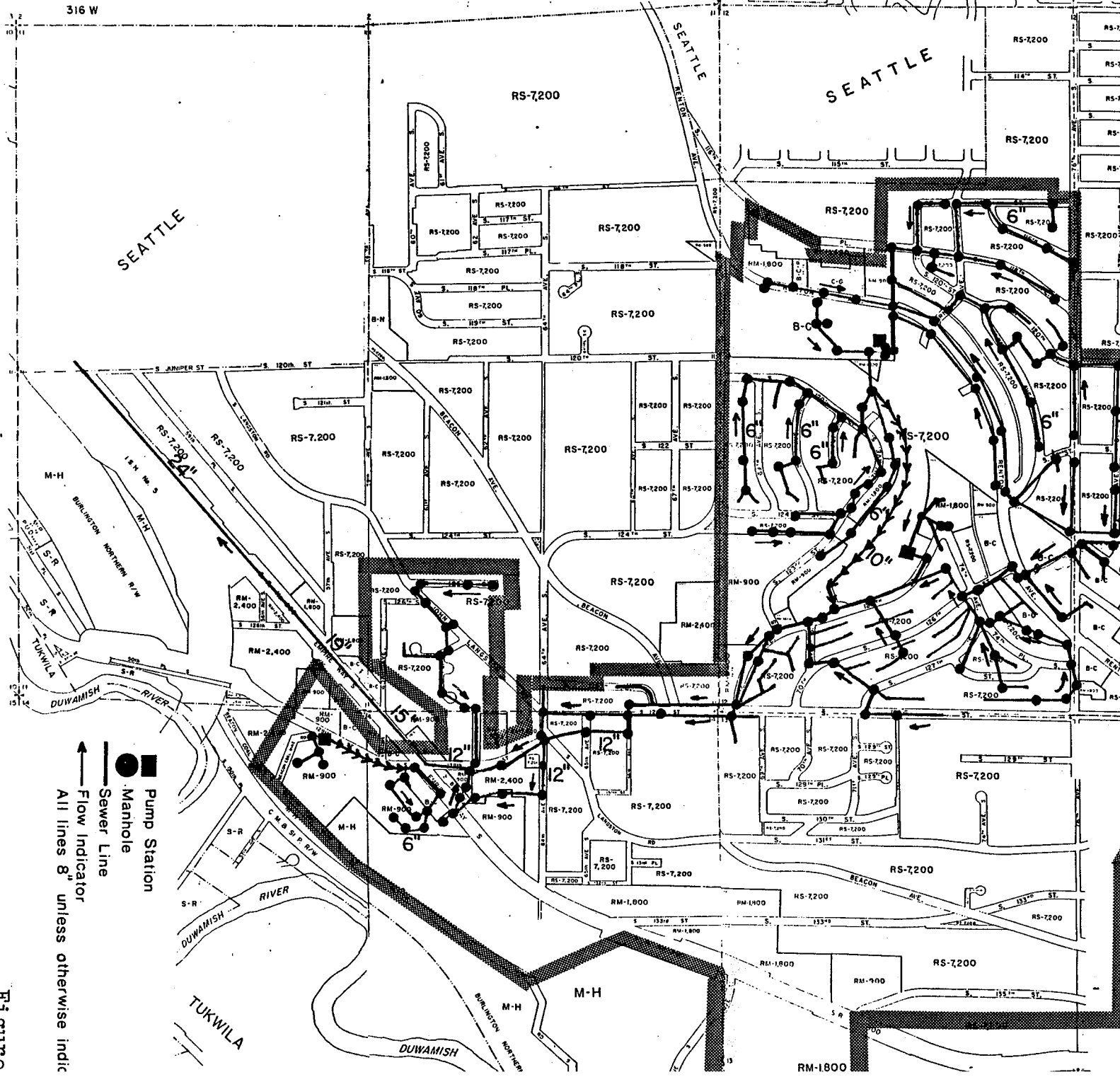

↑ Sewer Line
 ● Manhole
 ■ Pump Station
 → Flow Indicator
 All lines 8" unless otherwise indic

RT 111111

A small County-operated system with 58 residential connections connects into the Skyway system at South 129th and Empire Way. Responsibility for this system, the Olson sewer system, was transferred to the County by Water District 125 in January 1980.

FUTURE ADDITIONS

No specific County additions to the system are planned, but there have been several queries from developers regarding the construction of developer extensions from properties to the south of the existing system. Any requests will be reviewed on an individual basis to ensure compatibility with the system.

Although the proposed Langston ULID, located west of the existing Skyway system (see Figure 1) was not approved by the voters, it is expected that much of the area will eventually be served through the developer extension process. The general plan for the Langston ULID has received Metro and County Council approval.

LAND USE

The majority of the service area is zoned for residential use, with several areas zoned for varying levels of business and higher density dwellings (see Figure 3). The service area is not within any existing community comprehensive plan.

A County park, Skyway Park, is located in the northern portion of the study area. The Thompson Elementary School is located on the eastern edge of the service area at 7812 South 124th Street and the Dimmitt Middle School is just outside the service area at 12320 80th Avenue South. Four other elementary

schools, Campbell Hill, Earlington, Lakeridge, and Bryn Mawr, are located near the service area. The Skyway library is also situated in the eastern portion of the service area.

Rainier Avenue South intersects the northeastern portion of the area and has several shopping centers and commercial buildings located along it.

The City of Seattle Skagit transmission line right of way, which is 200 feet wide, also intersects the northeastern portion of the area.

To the south of the district there are many larger parcels of land available for residential, multiple dwelling, and commercial development. Such development would require approval of developer extensions to the existing County system.

Public Service Agencies

School Service	Provided by Renton School District
Fire Protection	King County Fire Protection Districts Nos. 1 and 20
Police Protection	King County Precinct No. 4
Water Districts	Seattle Water Department and Water District Nos. 125 and 128
Public Transportation	Metro Transit
Telephone Service	Pacific Northwest Bell
Recreation Facilities	King County Skyway Park
Power	Seattle City Light

POPULATION

The service area includes portions of census tracts 261 and 260.01 (see Figure 4). In 1979 the Puget Sound Council of Governments prepared population projections for the region based upon Area Allocation Model (AAM) districts using 1976 as a base year. The service area is located with AAM 3810 which consists of census tracts 261 and 260 (prior to the subdivision of 260 into 260.01 and 260.02), and 119.

Table 1 indicates some of the demographic information pertinent to the service area.

DESIGN STANDARDS

All extensions or additions to the sewer system must adhere to the County design and material standards.

Construction plans must be approved by the King County Department of Public Works.

Sewer Sizing

Sewers shall be designed with sufficient capacity to carry peak flows from the tributary area at ultimate development. The minimum diameter of gravity laterals shall be eight inches and side sewers, six inches. Four-inch sewers to serve a single residence will be permitted from property line to the house.

The ability of a sewer to transport suspended solids contained in sewage is related to the velocity of flow in the sewer. A velocity of two feet per second is generally considered to be the minimum which will keep pipe surfaces clean and free of deposited material.

CENSUS AREAS

Rainier Beach

LAKE

Kennydale

WASHINGTON

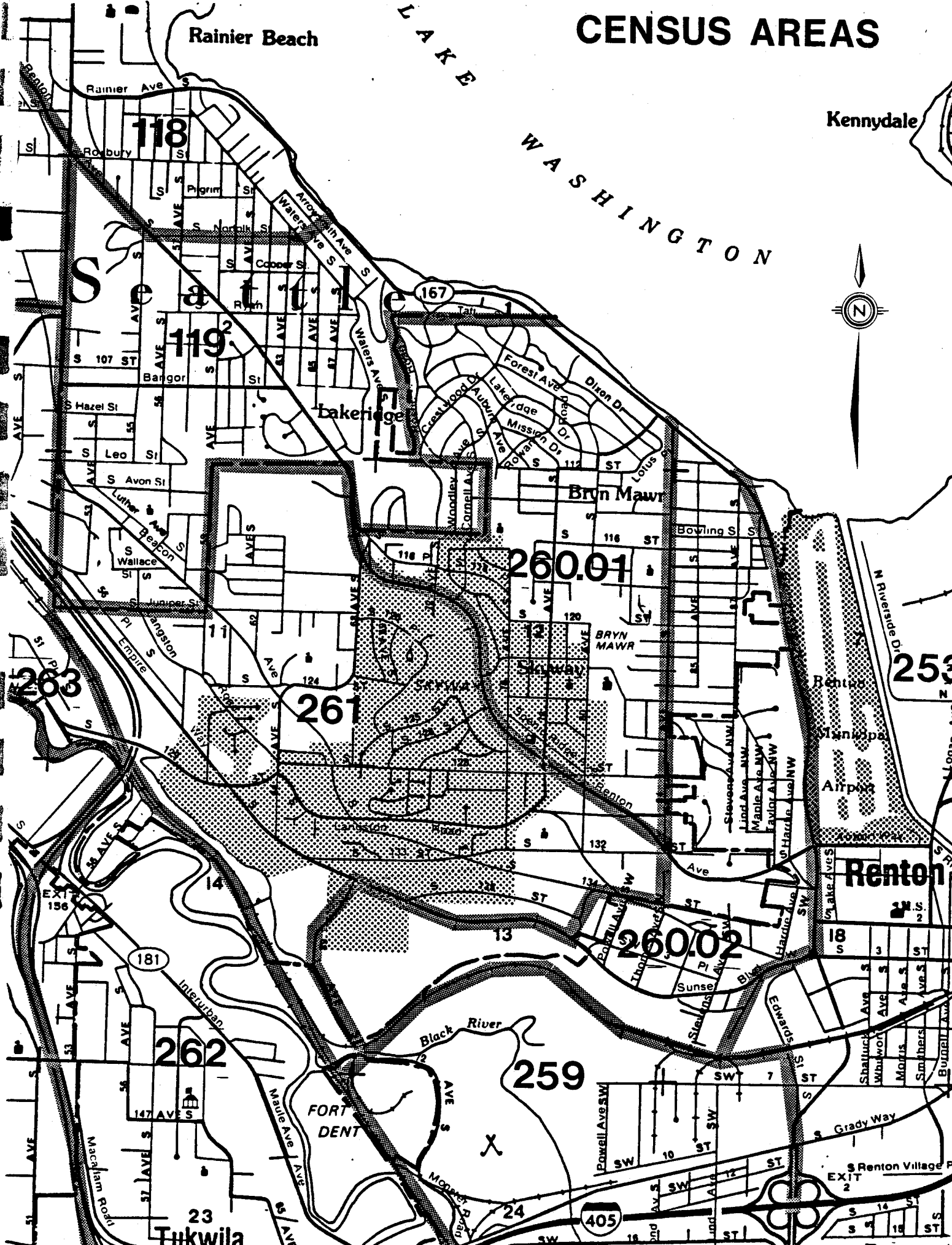

Diameters of gravity sewers constructed of concrete are determined by means of Manning's pipe friction formula, using a roughness coefficient "n" of 0.0013 and considering the pipe to be flowing 0.8 full.

Table 1

Population

	<u>1970</u>	<u>1980</u>	<u>1990</u>
AAM District 3810	20,292	19,612	19,082
City of Seattle	530,831	503,501	523,227
King County	1,159,375	1,207,756	1,367,440

Single Family/Multiple Family Units in the AAM District

Single Family Households	6,259	6,094
Multiple Family Households	<u>1,088</u>	<u>1,318</u>
TOTAL	7,347	7,412

AAM District Population by Age Groups

	<u>0-17</u>	<u>18-24</u>	<u>25-44</u>	<u>45-64</u>	<u>65+</u>
1980	5,550	2,459	5,652	4,141	1,810
1990	5,282	1,796	5,846	3,939	2,219

AAM District Number of Households by Size

	<u>1</u>	<u>2</u>	<u>3</u>	<u>4</u>	<u>5</u>	<u>6+</u>	<u>TOTAL</u>
1980	1,423	2,841	1,244	887	542	410	7,347
1990	1,525	3,000	1,251	783	482	371	7,382

Table 2

Minimum Slopes for Sewer Pipes

<u>Sewer Size</u>		<u>Minimum Slope Ft./Ft.</u>
4" & 6"	(for house sewers and side sewers)	0.0200
8"	(for main)	0.0040
8"	(end run)	0.0050

The design of force mains is predicated on the basis that they flow full and under pressure. Again, as in the case of gravity sewers, the mains must be capable of carrying the peak flow from a given area.

Force main design shall be based on a minimum self-cleaning velocity of three feet per second. The roughness coefficient will depend on the pipe material selected.

Developer Extensions of the Sewer System

In accordance with policy developed for the King County sewer systems, developer extension agreements will be negotiated which will include the following requirements:

1. Plans and specifications shall be prepared by a licensed professional engineer.
2. Plans and specifications shall be approved by the Washington State Department of Ecology, the Municipality of Metropolitan Seattle (METRO) and King County.
3. Inspection and testing shall be by an engineer approved by King County.
4. An area charge shall be paid prior to connection.
5. Upon acceptance of the work, the facilities shall be deeded to King County.

FINANCES

Currently, district revenue is obtained by means of an annual maintenance assessment which is prepared and collected by the King County Office of Finance. The King County Department of Public Works Utilities Section provides the Office of Finance with the necessary information required to prepare and send the maintenance assessments to the customer.

Additional revenue is generated by a side sewer connection permit fee and a connection charge for new connections, however, these charges have not been a significant income factor in recent years.

The 1983 maintenance and operation budget for the system was \$207,525.

INVENTORY -- SKYWAY/OLSON

<u>K.C. TAG NO.</u>	<u>ITEM</u>	<u>COST</u>	<u>YEAR PURCHASED</u>	<u>APPROX. VALUE</u>
83396	Toro Lawn Mower	\$319.45	1982	\$150.00
81652	Air Monitor	685.10	1979	300.00
81673	Gas Weedeater	158.04	1981	125.00

WARRANTY DEED

The Grantors, JOHN VERTREES and LILA VERTREES, his wife, and JOHN HARER and ALICE HARER, his wife, for and in consideration of TEN DOLLARS (\$10.00) and other valuable consideration in hand paid, convey and warrant to KING COUNTY SEWER AND DRAINAGE DISTRICT NO. 4, a municipal corporation, the following described real estate, situated in the County of KING, State of Washington, to-wit:

That portion of the SW $\frac{1}{4}$ of the NW $\frac{1}{4}$ of Section 12, Township 23 North, Range 4 E.W.M., situated in King County, State of Washington, described as follows:

Starting at the SE corner of the SW $\frac{1}{4}$ of the NW $\frac{1}{4}$ and running thence 30 feet westerly along the south line of the SW $\frac{1}{4}$ of the NW $\frac{1}{4}$ to the western boundary of 72nd Ave. So. the true point of beginning; thence continuing westerly along said south line 80 feet; thence northerly 90° from last bearing 80 feet; thence easterly 90° for 80 feet, more or less, to the said western boundary of 72nd Avenue South; thence southerly along said western boundary for 80 feet, more or less, to the true point of beginning.

DATED this 4th day of August, 1965.

John Vertrees
JOHN VERTREES
Lila E. Vertrees
LILA VERTREES

John Harer
JOHN HARER
Alice Harer
ALICE HARER

STATE OF WASHINGTON,)
County of KING.) SS

On this day personally appeared before me JOHN VERTREES and LILA VERTREES, his wife, and JOHN HARER and ALICE HARER, his wife, to me known to be the individuals described in and who executed the within and foregoing instrument, and acknowledged that they signed the same as their free and voluntary act and deed, for the uses and purposes therein mentioned.

GIVEN under my hand and official seal this 4th day of August 1965.

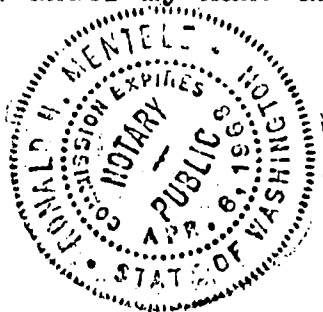

Ronald H. Mentel
Notary Public in and for the State of Washington, residing at Seattle.

Filed for Record Aug. 17 1965 2:30 P.M.
Request of Board of County Commissioners
ROBERT A. MORRIS, County Auditor